

# Montageanleitung B23 Hybrid

konfektionierbares Steckergehäuse mit Crimpanschluss, axial,  
4x4mm<sup>2</sup>+2x2,5mm<sup>2</sup> + 4xAWG22, ENP: Powerbuchse / Datenstift

## Stückliste

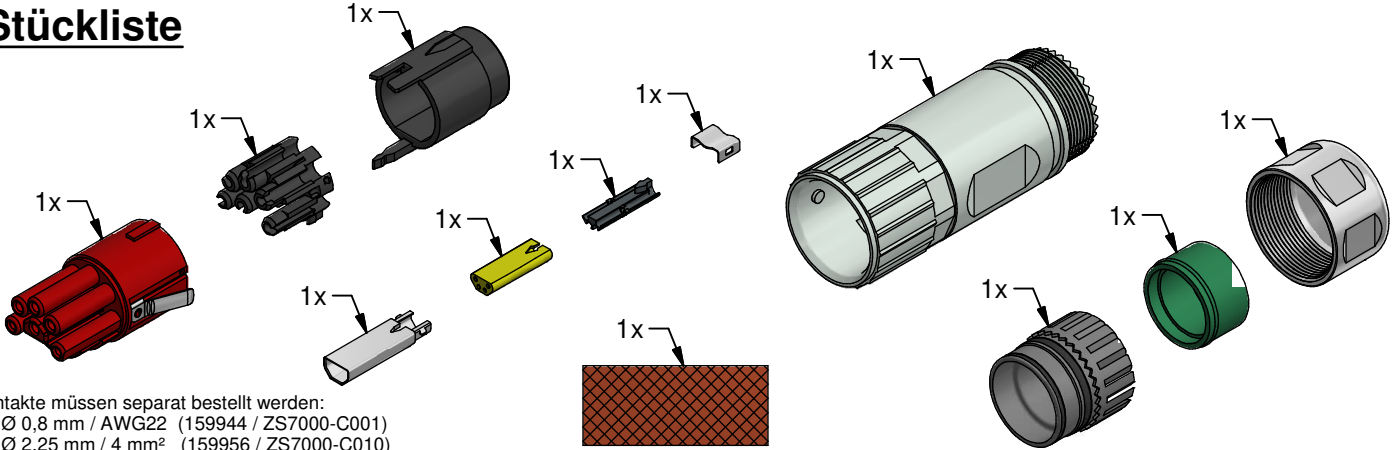

Kontakte müssen separat bestellt werden:  
4 x Ø 0,8 mm / AWG22 (159944 / ZS7000-C001)  
4 x Ø 2,25 mm / 4 mm<sup>2</sup> (159956 / ZS7000-C010)  
2 x Ø 1,8 mm / 2,5 mm<sup>2</sup> (183159 / ZS7000-C013)

**Laufrichtung beachten!**

1 Einzelteile auf Leitung schieben

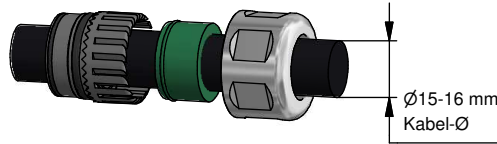

**Füllstoffe bündig mit Kabelmantel wegschneiden!**

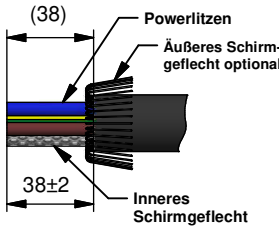

3

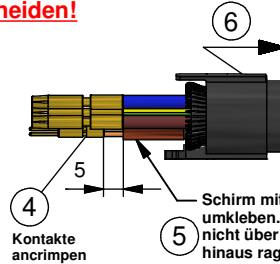
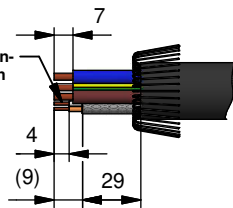

4 Kontakte ancrimpen

5 Schirm mit Kupferband umkleben. Schirm darf nicht über Kupferband hinaus ragen.

7

Powerkontakte einclippen (6x)  
Ø 0,8 mm - AWG22  
Ø 2,25 mm - 4 mm<sup>2</sup>  
Ø 1,8 mm - 2,5 mm<sup>2</sup>

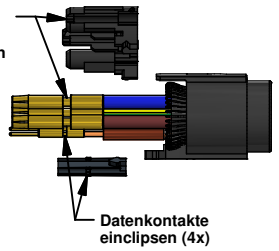

Datenkontakte einclippen (4x)

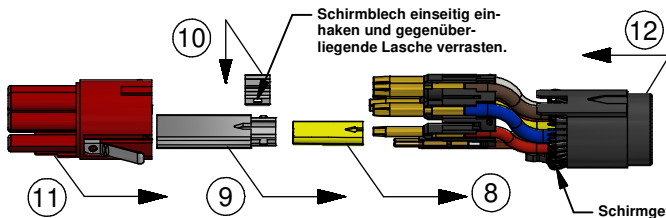

11

9

10

8

12

13

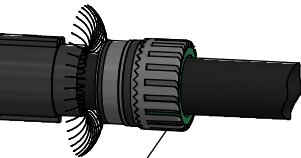

14

Schirmgeflecht muss gekürzt werden und darf nicht über O-Ring ragen!

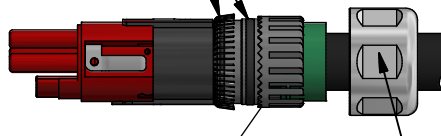

SW26

SW27  
Drehmoment 5Nm

**Achtung: Ansicht von Kabelausgang dargestellt! Auf richtige Farbwahl achten!**

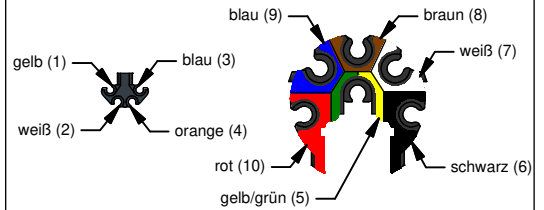

Farbring optional  
ZS7300-B005 (rot)  
ZS7300-B006 (gelb)  
ZS7300-B007 (blau)  
ZS7300-B008 (grün)

Codiernut für gewünschte Codierung wählen!

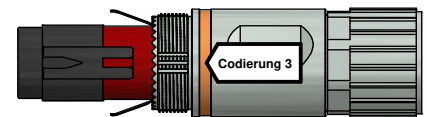
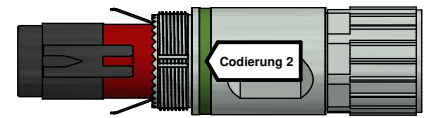
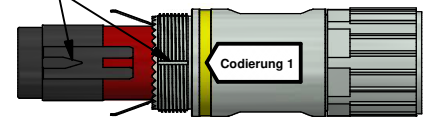

## Werkzeug / Zubehör

Crimpzange

Crimpeinsatz / Locator

ZB8810-0000

ZB8810-0002

# Assembly instruction B23 hybrid

field attachable plug housing with crimp connection, axial.  
 4x4mm<sup>2</sup>+2x2,5mm<sup>2</sup> + 4xAWG22, ENP: power (female) / data (male)

## parts list

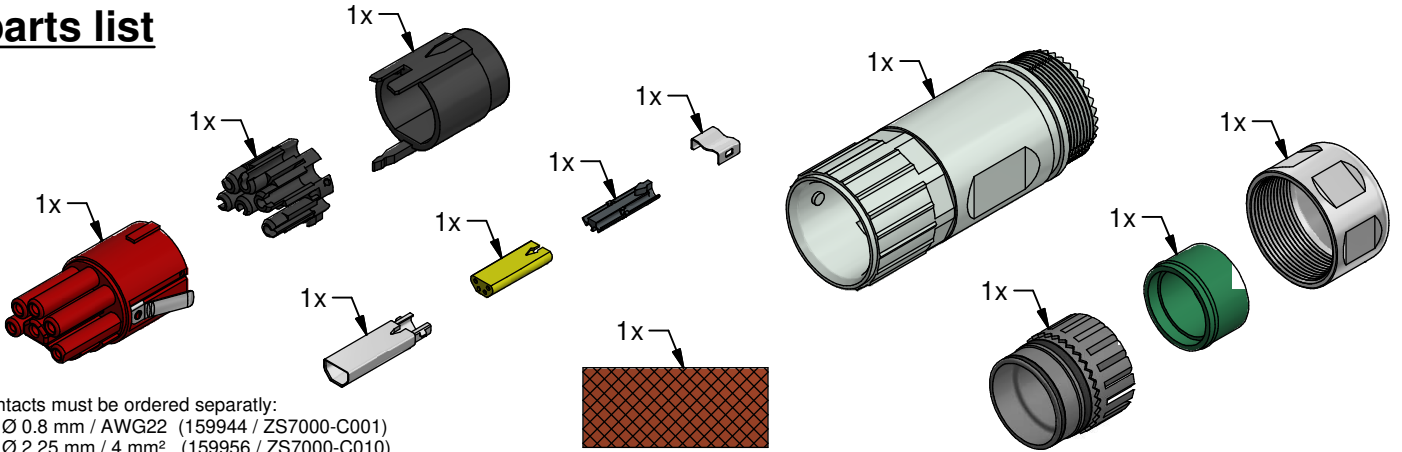

Contacts must be ordered separately:  
 4 x Ø 0.8 mm / AWG22 (159944 / ZS7000-C001)  
 4 x Ø 2.25 mm / 4 mm<sup>2</sup> (159956 / ZS7000-C010)  
 2 x Ø 1.8 mm / 2.5 mm<sup>2</sup> (183159 / ZS7000-C013)

Please consider the cable direction!

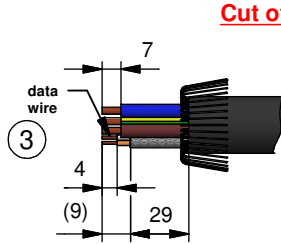
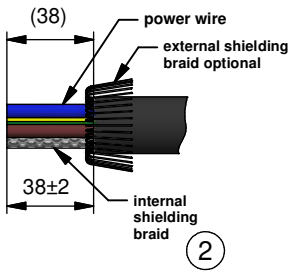
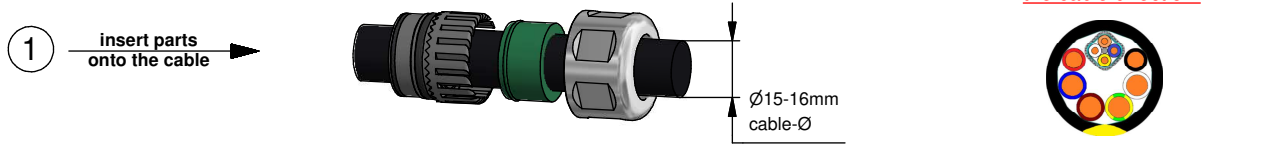

Cut off the fillers!

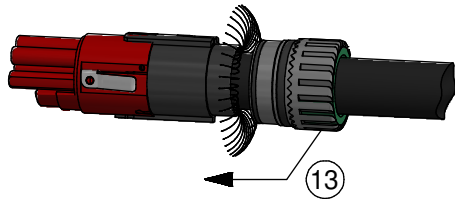
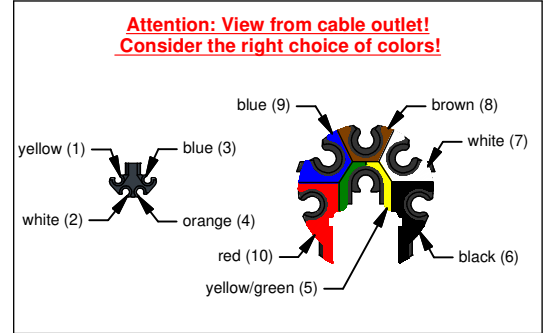
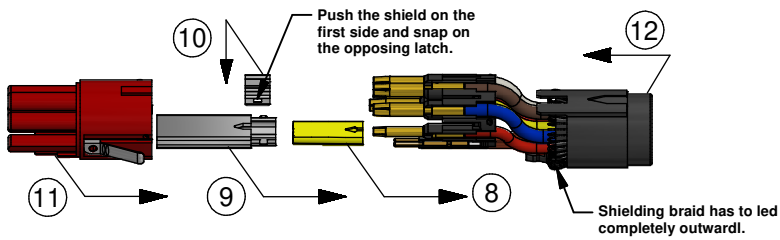
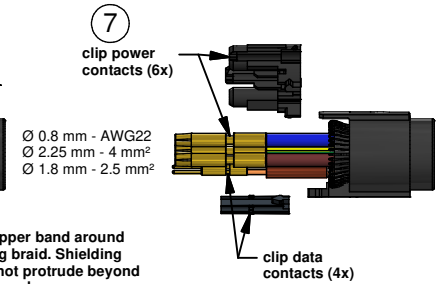
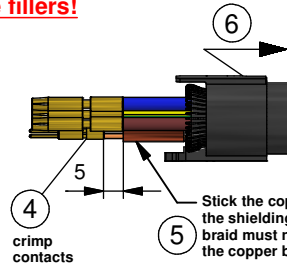

color ring optional  
 ZS7300-B005 (red)  
 ZS7300-B006 (yellow)  
 ZS7300-B007 (blue)  
 ZS7300-B008 (green)

Shielding braid has to be shorten. It isn't allowed to protrude above the o-ring.

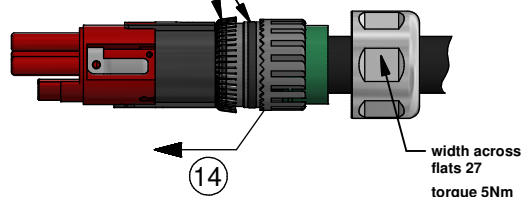
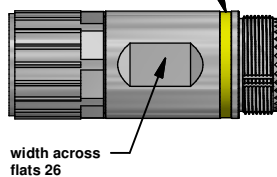

Select the right coding!

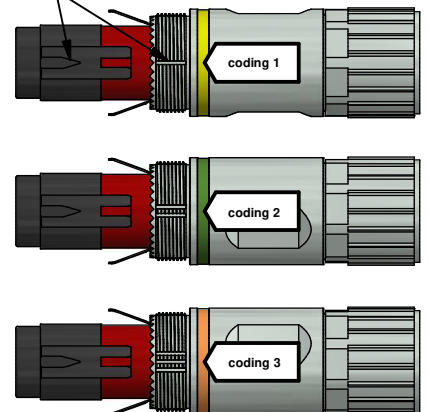

Beckhoff®, TwinCAT®, EtherCAT®, EtherCAT P®, Safety over EtherCAT®, TwinSAFE®, XFC® and XTS® are registered trademarks of and licensed by Beckhoff Automation GmbH. Other designations used in this publication may be trademarks whose use by third parties for their own purposes could violate the rights of the owners.

© Beckhoff Automation GmbH & Co. KG 08/2016

790-960000 / 7901A291 Rev. c  
 Beckhoff art.-no.: ZS7300 - A004

**BECKHOFF**

## tools / accessory parts

crimping tool	crimping insert / locator
ZB8810-0000	ZB8810-0002

The information provided in this brochure contains merely general descriptions or characteristics of performance which in case of actual application do not always apply as described or which may change as a result of further development of the products. An obligation to provide the respective characteristics shall only exist if expressly agreed in the terms of contract.